

Sterlitech in-line pressure filtration holders are designed for use in pressure applications, either in batch or continuous filtration processes.

Polypropylene holders are ideal for sterilizing liquids and aseptic sampling of liquids or gases at point-of-use.

SPECIFICATIONS

Model	PP 25	PP 47
Part Number	540100	501200
Materials		
Body and support screens	Polypropylene	
O-ring	Silicone	
Connections		
Inlet	Female Luer Lok	Combination 1/4" NPTM, female luer slip; outlet tubing adapter
Outlet	Male Luer Slip	
Pressure		
At 25°C	5.0 kg/cm ² (71 psi)	
At 80°C	3.0 kg/cm ² (42 psi)	
Max. Operating Temp.	80°C (liquids)	
Membrane filter size	25 mm	47 mm
Pre-filter size (if used)	21 mm	42.5 mm
Filtration area	3.5 cm ²	13.5 cm ²



CLEANING AND MAINTENANCE

- Routinely inspect surfaces for nicks and rough edges.
- Use Tweezers (Pad) Miracle Tip Ends or other blunt tipped forceps to remove O-rings, do not use sharp tools.
- These units can be used with most neutral aqueous solutions and alcohols. We recommend replacing the silicone O-rings with Viton or EPR when using aldehydes, ethers, photo resists, bases, and weak acids.
- Clean all components with a standard, low-alkaline, non-abrasive detergent such as Alconox or Liquinox. Rinse with hot tap water followed by a final rinse with distilled or deionized water.
- To sterilize, filter holders may be autoclaved assembled or as components.
 - Holders should only be finger-tight during sterilization.
 - Autoclave the holder at 121°C (250°F) and 15 psi for 20 minutes. SLOW EXHAUST ONLY.
 - After the holder has cooled to room temperature, tighten locking ring as described in Assembly.

ASSEMBLY AND OPERATION

1. Be sure that support (D) is seated firmly in base (F).
2. Center membrane filter (MF) on top of support.
3. Center prefilter (PF) on top of filter (if used).
4. Check to be sure sealing O-ring (B) is seated firmly in inlet cap (C).
5. Place inlet cap (with support, D1) on top of filter, aligning tabs in slots in base (F) to lock in place.
6. PP47 only: Secure inlet cap O-ring (B1) and outlet base O-ring (E). Be sure support (D1) is firmly seated in inlet cap.
7. Tighten locking ring (A) until resistance is felt (For PP47: continue to tighten as far as possible for best seal). Extensions may not line up depending on thickness of membrane and use of prefilter.
8. Slip outlet adapter (G) onto outlet if required (PP47 only).

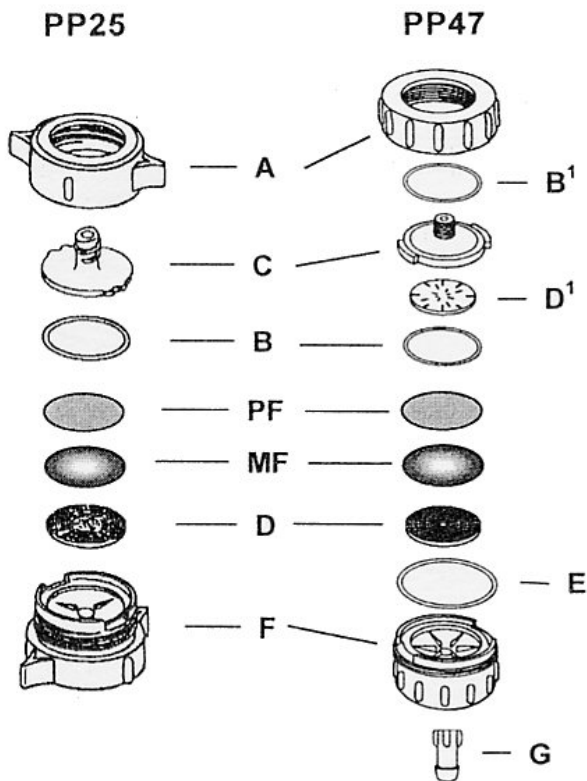

TYPICAL INITIAL FLOW RATES*

Membrane Pore Size (µm)	PP 25	PP 47
0.20	35	250
0.45	80	600
1.20	320	1700
3.0	740	2800

*Units in mL/min. Test conditions: water, nitrocellulose membrane, 1 kg/cm² (14 psi) differential pressure, 20°C.

ORDERING GUIDE

	Part	PP 25	PP 47
A	Locking ring (outer)	540101	501201
B	Sealing O-ring (silicone)	540102	501204
B	Sealing O-ring (Viton)	540106	530108
B	Sealing O-ring (EPR)	540107	530109
C	Inlet cap	540108	501202
D	Support screen	540104	501004
E	Outlet base O-ring (silicone)	-	501208
E	Outlet base O-ring (Viton)	-	501210
E	Outlet base O-ring (EPR)	-	501211
F	Outlet base	540103	501203
G	Outlet adapter (males luer slip to hose barb)	-	501013